



SO24TE/S/TH



FEATURES

- Control heat and airflow expertly with a convection fan to create just the right cooking environment for everything from Cornish hens to cherry pie to butternut squash
- Insert a temperature probe to tell you exactly when it is done—and in Gourmet Mode, it will alert you the moment the dish is ready.
- Includes options such as self-clean and quick preheat
- Small size and versatile design to fit in any kitchen
- Integrates beautifully into surrounding cabinetry with flush installation
- Promotes excellent visibility via two bright halogen lights and large, double-panel-glass door windows

ACCESSORIES

- Enameled Broil Pan - Legacy
- Full-Extension Rack
- Perforated Pan - 12 3/4" x 1 1/2" x 7"
- Perforated Pan - 17 3/4" x 1 1/4" x 15" - Legacy
- Perforated Pan 12 3/4" x 2 1/2" x 7"
- Porcelain Steam Enameled Broil Pan - Legacy
- Pro Handle
- Solid Pan - 12 3/4" x 1 1/2" x 7"
- Solid Pan - 17 3/4" x 1 1/4" x 15" - Legacy
- Solid Pan 12 3/4" x 1 1/4" x 14" - Legacy
- Temperature Probe - Legacy

Accessories available through an authorized dealer.  
For local dealer information, visit [subzero-wolf.com/locator](https://subzero-wolf.com/locator).





PRODUCT SPECIFICATIONS

Model	SO24TE/S/TH
Dimensions	23 1/2"W x 23 1/2"H x 21 1/2"D
Oven 1 Interior Dimensions	18"W x 13 3/4"H x 16"D
Overall Capacity	2.4 cu. ft.
Usable Capacity	1.6 cu. ft.
Door Clearance	18 1/8"
Weight	119 lbs
Electrical Supply	240/208 VAC, 60 Hz
Electrical Service	20 amp dedicated circuit
Power Cord Length	6 Feet
Receptacle	NEMA 6-20R grounding-type

ELECTRICAL

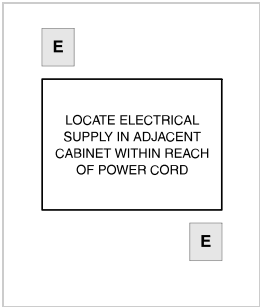

**NOTE:** Dimensions in parenthesis are in millimeters unless otherwise specified

DIMENSIONS

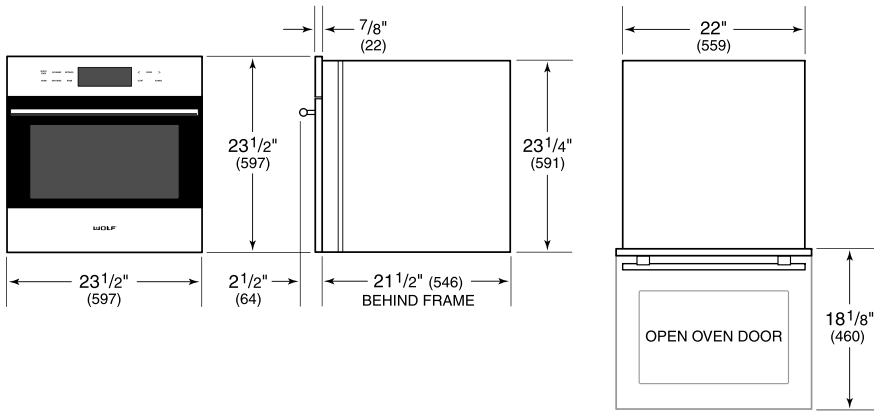

FLUSH INSTALLATION

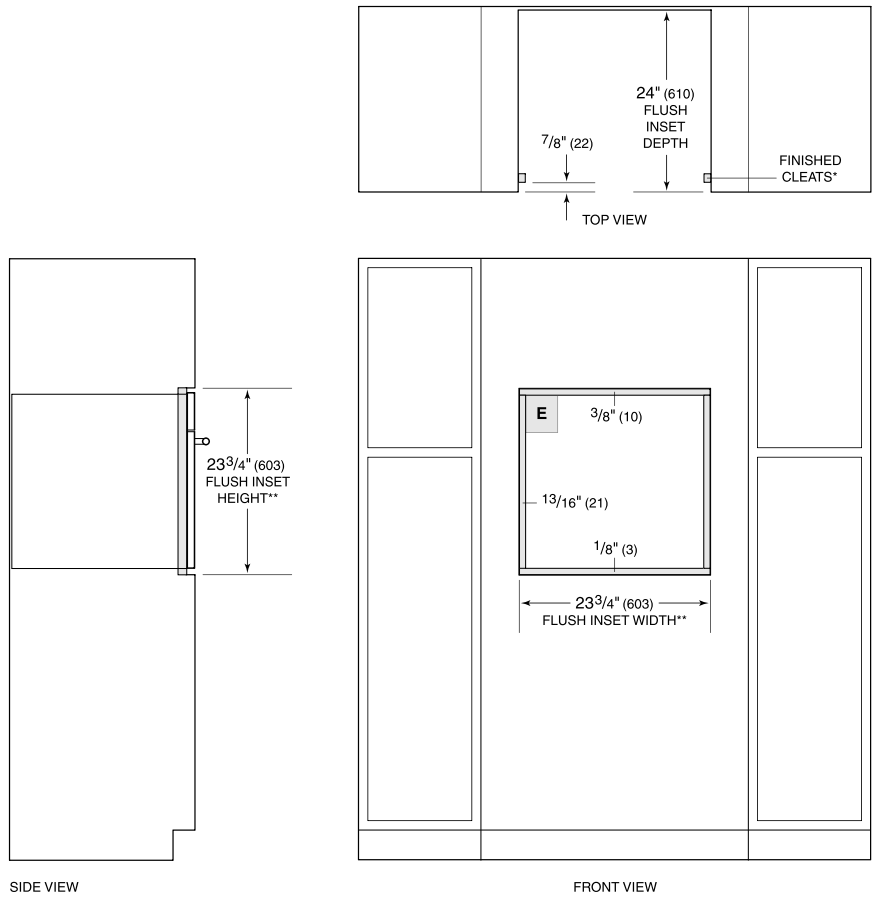

*\*Will be visible and should be finished to match cabinetry.  
\*\*Dimension provides minimum reveals.*