

FRAMPAR (0000034) Model 685F/695F - Accessory Trim Kit Allows Stainless Steel Panel Above and Below Glasswell

⚠ CAUTION

Panels may have sharp edges which could inflict serious personal injury. Use care when handling. This carton and its contents are heavy and unstable. If carton were to fall, it could cause serious injury. The carton should be laid down when unpacking.

NOTE: With stainless steel panels, protective tape must be removed off front panel before installing.

NOTE: Refrigerator decorative panel will be same size as freezer panel when using kit.

<u>CONTAINS:</u>	<u>QUANTITY</u>	<u>PART NUMBER</u>	<u>DESCRIPTION</u>
	1	0186660	685 Refrigerator Partial Panel
	1	0186670	695 Refrigerator Partial Panel
	1	3517110	Framed Transition Trim
	7	6200120	Screws, #10-12 x 1/2 Truss HD
	1	3758437	Instructions

PROCEDURE:

1. Please refer to **CAUTION** and **NOTES** above.
2. For additional install information/instruction, see Figure 1.
3. Remove water grille, touchpad* and bezel by removing mounting screws.
**Remove touchpad by extracting two plastic rivets on underside of touchpad with small screwdriver, then rotate bottom away from door to release touchpad.*
4. Remove door handle molding trim strips by using a piece of tape, then pulling away from handle assembly. This will expose door handle mounting screws.
5. Using a phillips screwdriver extract door handles screws and remove.
6. Install refrigerator and freezer panels.
7. Install framed transition trim on refrigerator door.
8. Install stainless steel door panel.
9. Install enclosed chipboard behind stainless steel panel.
10. Reinstall door handle by reinstalling door handle screws.
11. Reinstall bezel, touchpad and water grille.

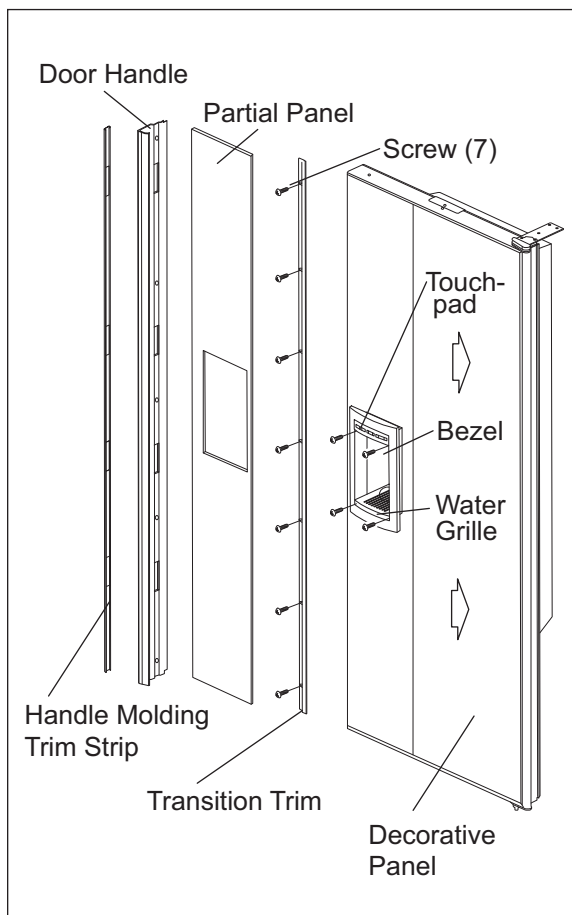

Figure 1

