

UC-24R



FEATURES

- Compact unit fits in anywhere
- Easy-access touch control panel
- Temperature range from 34°F to 45°F
- Bright interior lighting
- Clear utility bin for smaller items
- Two-liter bottle storage in door
- Spill-proof glass shelves for easy clean-ups

ACCESSORIES

- Dual Installation Kit
- Stainless Steel Door Panel with Pro Handle
- Stainless Steel Door Panel with Tubular Handle
- Undercounter Black Dual Kickplate
- Undercounter Door Lock Kit
- Undercounter Dual Lock Kit
- Undercounter Silver Dual Kickplate
- Undercounter Silver Kickplate
- Stainless Steel Pro Handles
- Stainless Steel Tubular Handles

Accessories are available through an authorized dealer.
For local dealer information, visit subzero-wolf.com/locator.



HANDLE ACCESSORIES

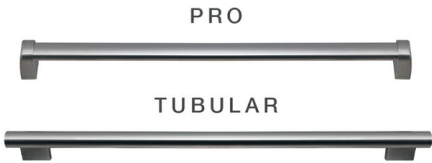

PRODUCT DETAILS

REFRIGERATOR

- 1 storage bin
- 3 glass shelves (2 adjustable; 1 stationary)
- 2 door bins

PRODUCT SPECIFICATIONS

Model	UC-24R
Dimensions	23 7/8"W x 34"H x 24"D
Refrigerator Capacity	5.7 cu. ft.
Door Clearance	25 3/8"
Weight	153 lbs
Electrical Supply	115 VAC, 60 Hz
Electrical Service	15 amp dedicated circuit

ELECTRICAL

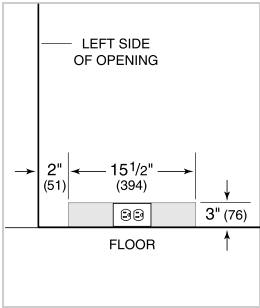

NOTE: Dimensions in parenthesis are in millimeters unless otherwise specified

INTERIOR VIEW

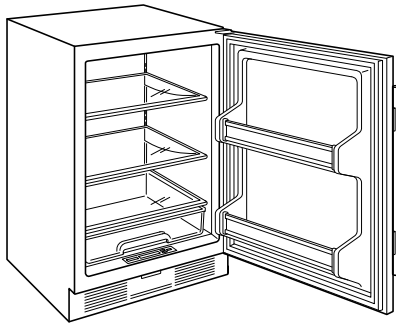

This illustration is intended for interior reference only and may not represent the exterior of the model being specified.

DIMENSIONS

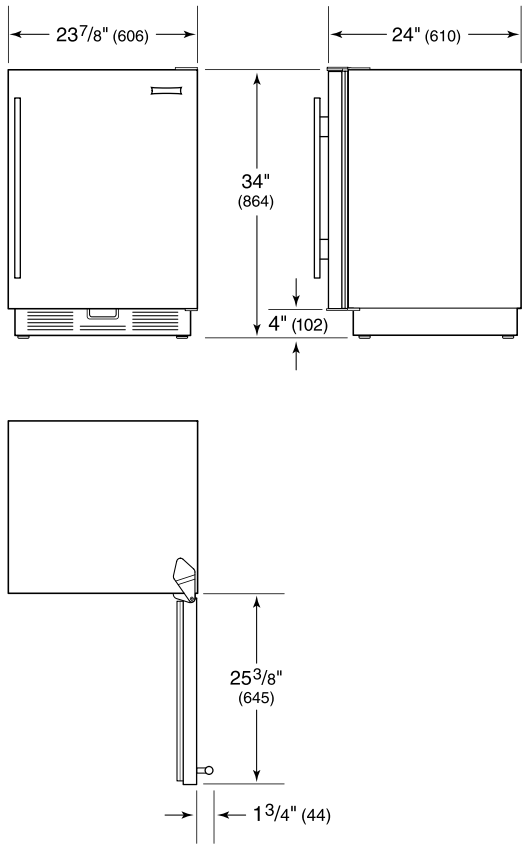

STANDARD INSTALLATION

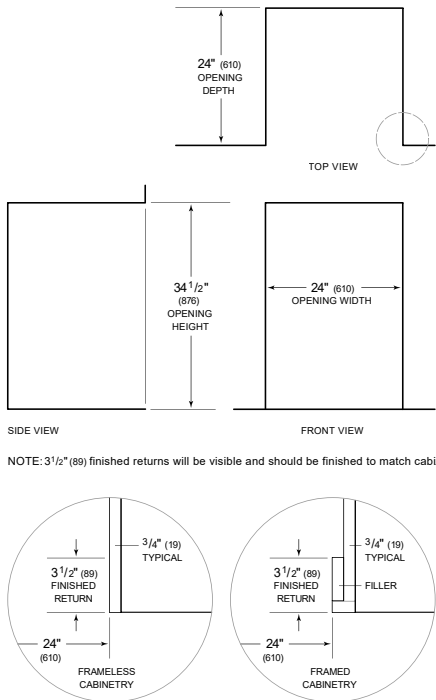

NOTE: 3 1/2" (89) finished returns will be visible and should be finished to match cabin