

WWD30



FEATURES

Distributes heat evenly from 80 to 200 degrees Fahrenheit using fans

Includes food presets, such as bread, cooked cereals, and pizza

Tested and approved for warming towels

Fits entrées and sides easily in its generous 30 inch drawer cavity

Includes hidden electronic controls

Offers automatic shut-off

ACCESSORIES

30" Stainless Professional Front Panel - 2" Thick

36" Stainless Professional Front Panel - 2" Thick

6-Piece Container Set

Warming Drawer Front Panel - Integrated

Warming Drawer Front Panels - M Series

Warming Drawer Front Panels - E Series

Stainless Steel Tubular, Pro and Black Tubular Handles

Warming Drawer Front Panels

Accessories available through an authorized dealer.

For local dealer information, visit subzero-wolf.com/locator.



FRONT PANEL OPTIONS



30" E SERIES TRANSITIONAL



30" E SERIES PROFESSIONAL



30" E SERIES CONTEMPORARY



30" M SERIES CONTEMPORARY



30" M SERIES TRANSITIONAL



30" M SERIES CONTEMPORARY STAINLESS



30" M SERIES PROFESSIONAL



30" L SERIES



30" INTEGRATED

PRODUCT SPECIFICATIONS

Model	WWD30
Dimensions	29 7/8"W x 10 3/8"H x 22 3/4"D
Capacity	1.6 cu. ft.
Electrical Supply	120 VAC, 60 Hz
Electrical Service	15 amp dedicated circuit
Power Cord Length	3 Feet
Receptacle	3-prong grounding-type

ELECTRICAL

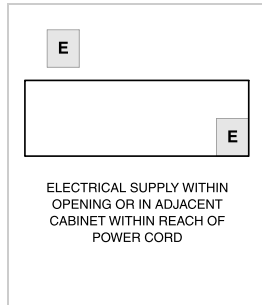

INSTALLATION WITH FRONT PANEL Accessory front panels may affect overall product dimensions and opening dimensions. Refer to [Reveal](http://subzero-wolf.com/reveal) for more information: subzero-wolf.com/reveal

NOTE: Dimensions in parenthesis are in millimeters unless otherwise specified

DIMENSIONS

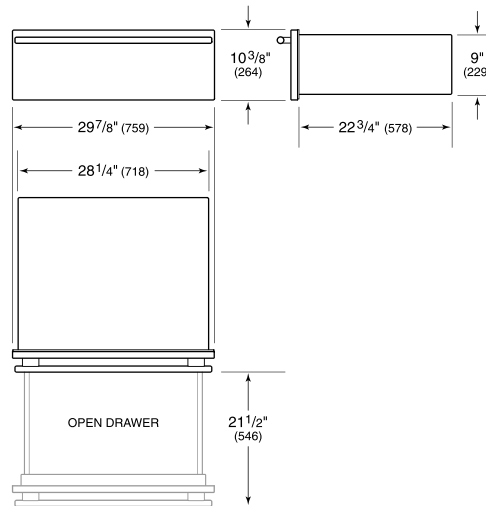

FLUSH INSTALLATION

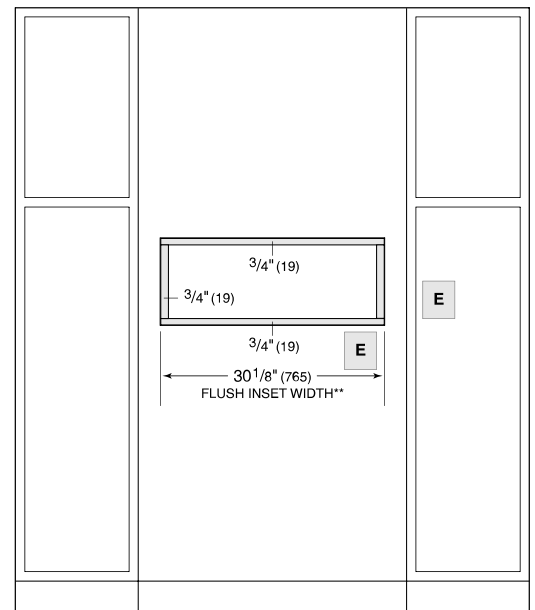
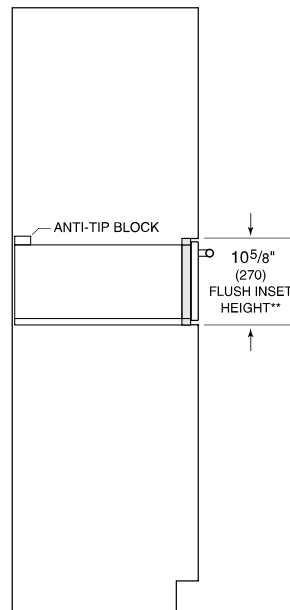
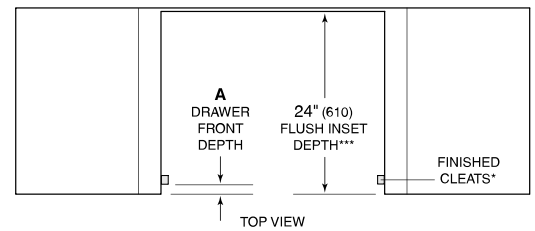

*Will be visible and should be finished to match cabinetry.
 **Dimension provides minimum reveals.
 ***24 1/8" (613) for E series contemporary drawer front.
 NOTE: Location of electrical supply within opening may require additional cabinet depth.