

ID-36R



FEATURES

- Accepts custom panels for an integrated look within cabinetry or stainless-steel accessory panels and handles to match other Sub-Zero, Wolf, and Cove products*
- Controls temperature within one degree of setpoint
- Assure maximum freshness with low-temp, high-humidity crisper and deli drawers
- Locks in cold air to ensure freshness with magnetic door seals
- Control brightness with soft-on LED lighting
- Open and close doors silently with soft-close technology

ACCESSORIES

- Crisper Cover
- Dual Installation Kit
- Egg Container
- Reduced Toekick Divider
- Stainless Steel Pro Handles
- Stainless Steel Tubular Handles
- Stainless Steel Drawer Panels With Pro Handles - 4" Toe Kick
- Stainless Steel Drawer Panels With Tubular Handles - 4" Toe Kick
- Stainless Steel Dual Installation Kickplates

Accessories are available through an authorized dealer.
For local dealer information, visit subzero-wolf.com/locator.



HANDLE ACCESSORIES

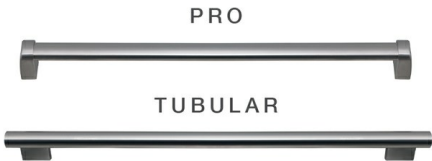

PRODUCT DETAILS

REFRIGERATOR

- Adjustable bottom drawer dividers
- LED lighting

PRODUCT SPECIFICATIONS

Model	ID-36R
Dimensions	36"W x 34 1/2"H x 24"D
Refrigerator Capacity	6.6 cu. ft.
Electrical Supply	115 VAC, 60 Hz
Electrical Service	15 amp dedicated circuit

ELECTRICAL

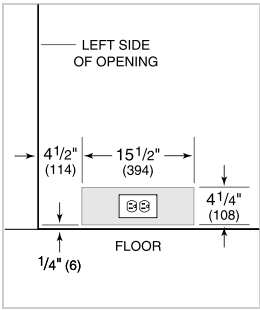

NOTE: The electrical outlet must be positioned with the grounding prong to the right of the thinner blades.

PANEL SPECIFICATIONS For complete panels specifications including width/height, weight requirements and thickness requirements visit subzero-wolf.com/reveal.

NOTE: Dimensions in parenthesis are in millimeters unless otherwise specified

INTERIOR VIEW

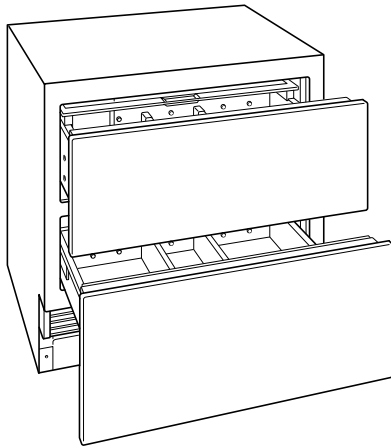

This illustration is intended for interior reference only and may not represent the exterior of the model being specified.

DIMENSIONS

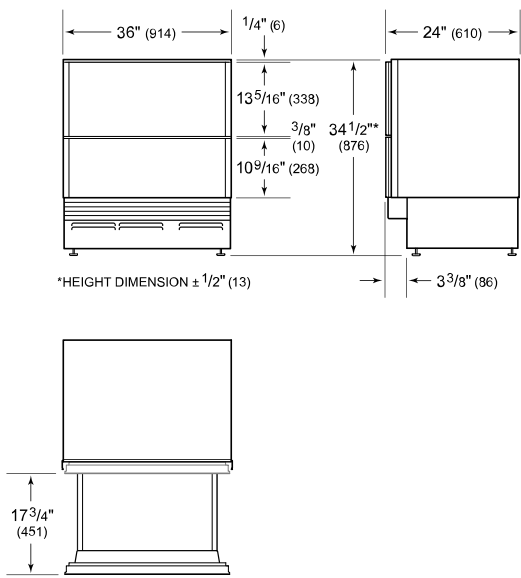

STANDARD INSTALLATION

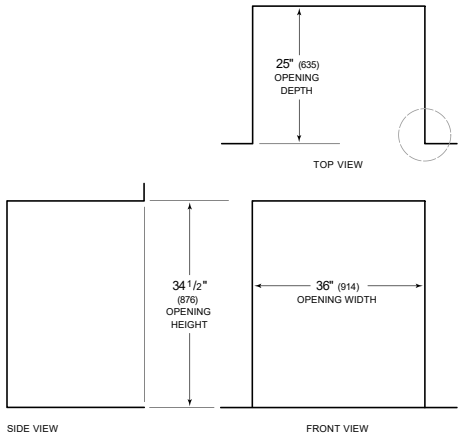

NOTE: 3 1/2" (89) finished returns will be visible and should be finished to match cabinetry

